

# TALL VECTOR™ 62 DIRECT VENT LINEAR GAS APPLIANCE



## Specifications: Single-sided

Model	BTU	Width		Height		Depth		Viewing Area
		Actual	Framing	Actual	Framing	Actual	Framing	
TLV62N	44,000	77 5/16	77 13/16	47 15/16	48 3/16	19 7/8	20 1/8	64 9/16 X 26 13/16
TLV62LN								
TLV62P	38,000	77 5/16	77 13/16	47 15/16	48 3/16	19 7/8	20 1/8	
TLV62LP								

## Dimensions: Single-sided

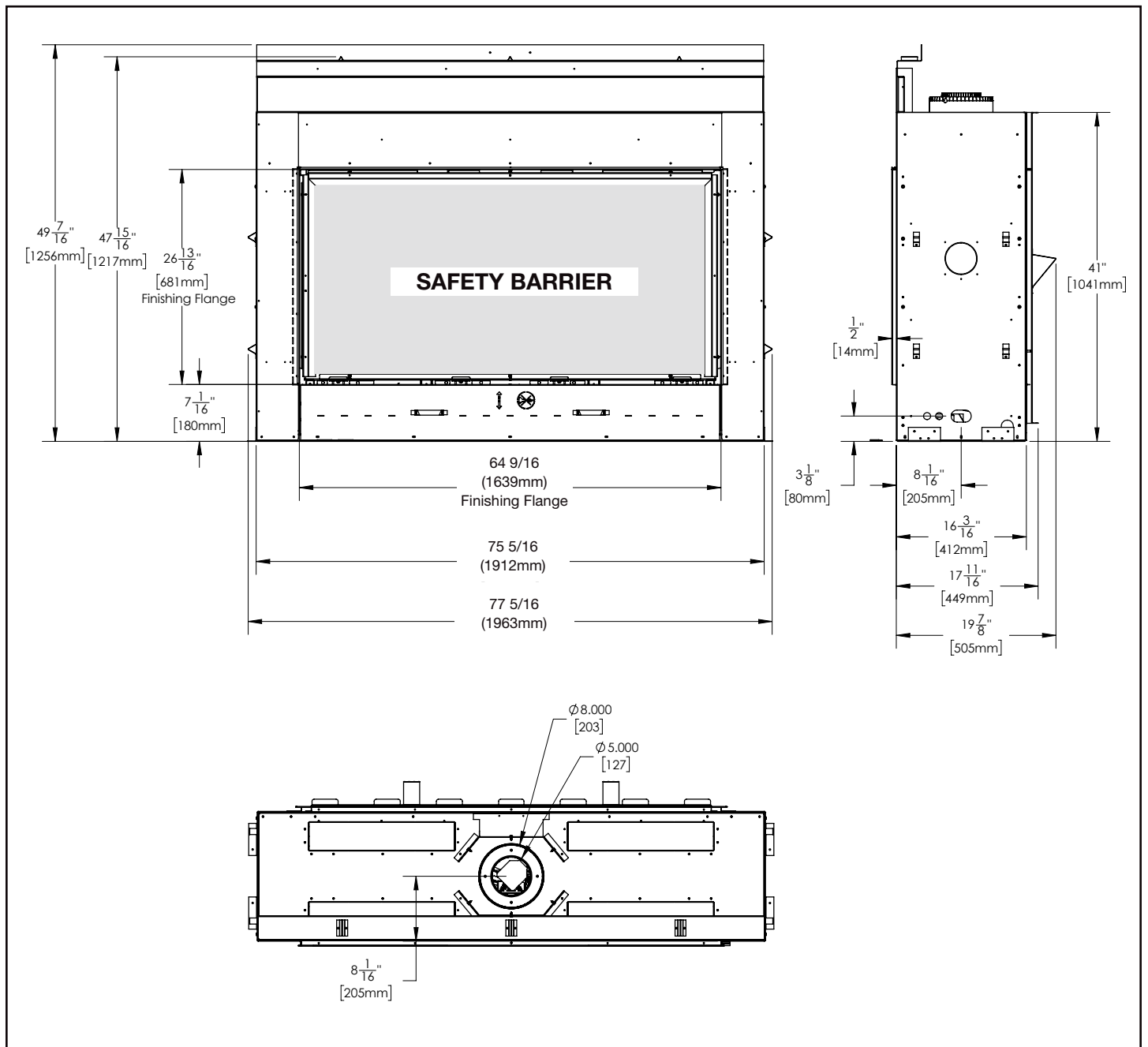

Product information provided is not complete and is subject to change without notice. Please consult the installation manual for the most up to date installation information.

W415-4143 / C-0 / 04.09.24

# TALL VECTOR™ 62 DIRECT VENT LINEAR GAS APPLIANCE



## Specifications: See-through

Model	BTU	Width		Height		Depth		Viewing Area
		Actual	Framing	Actual	Framing	Actual	Framing	
TLV62N2	44,000	77 5/16	77 13/16	47 15/16	48 3/16	16 3/16	16 3/16	64 9/16 X 26 13/16
TLV62LN2								
TLV62P2	38,000	77 5/16	77 13/16	47 15/16	48 3/16	16 3/16	16 3/16	
TLV62LP2								

## Dimensions: See-through

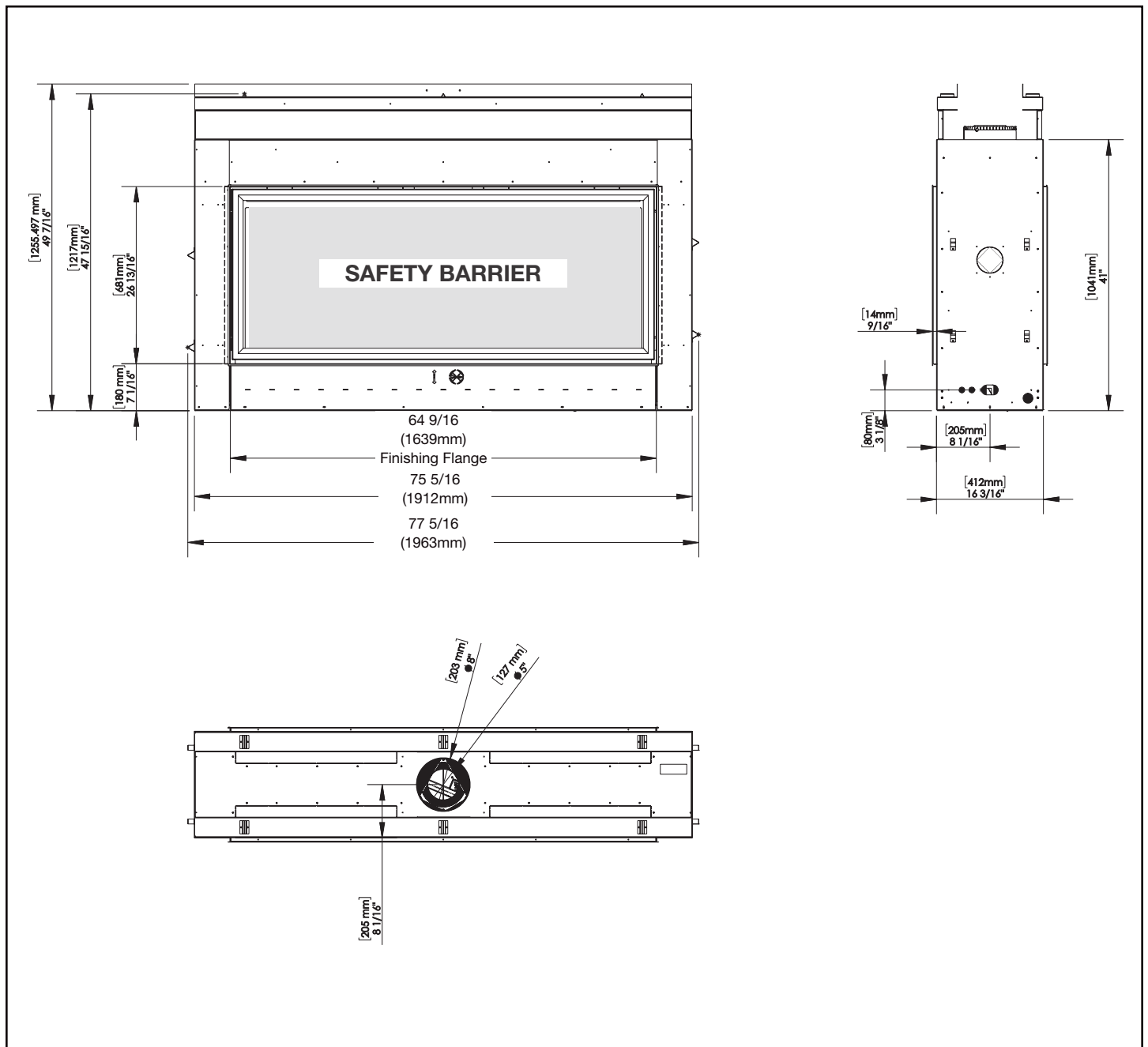

Product information provided is not complete and is subject to change without notice. Please consult the installation manual for the most up to date installation information.

W415-4143 / C-0 / 04.09.24

# TALL VECTOR™ 62 DIRECT VENT LINEAR GAS APPLIANCE



Product information provided is not complete and is subject to change without notice. Please consult the installation manual for the most up to date installation information.

## Finish Framing

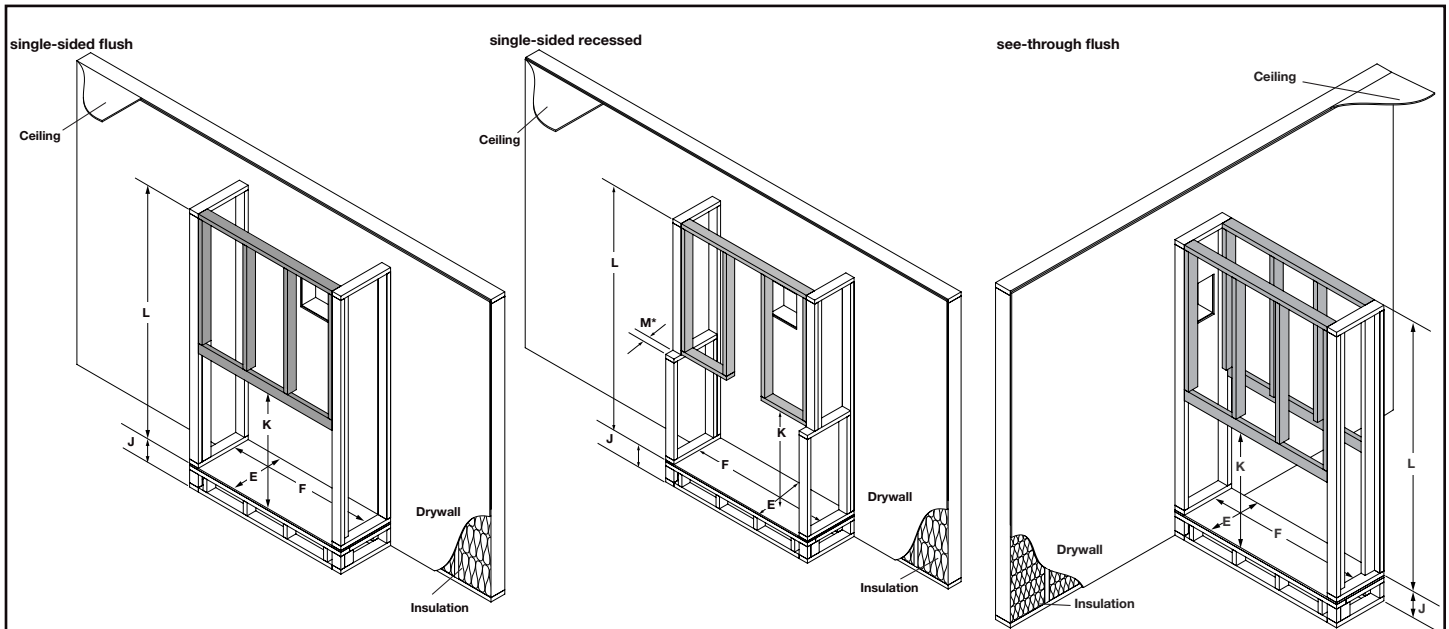

Ref.	TLV62 / TLV62L single-sided
K	48 3/16" (1224mm)
E	20 1/8" (511mm)
F	77 13/16" (1976mm)
J	Optional - Appliance does not need to be elevated above floor.
L	91" (2311mm)
M*	3" (76mm)

Ref.	TLV62_2 / TLV62L2 see-through
K	48 3/16" (1224mm)
E	16 3/16" (411mm)
F	77 13/16" (1976mm)
J	Optional - Appliance does not need to be elevated above floor.
L	91" (2311mm)

\*Can only be increased to 4" max by building a protrusion.

### note:

The TLV series requires a minimum enclosure/ceiling height, as illustrated (dimension L), measured from the bottom of the appliance. For temperature requirements, this area must be left unobstructed. Some venting configurations that require more vertical rise will require a larger enclosure to provide minimum vertical clearance between vent pipes and combustibles.

## Combustible Mantel Clearances

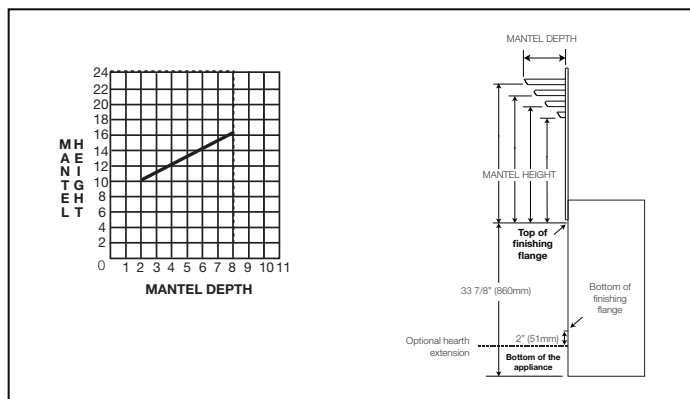

## Appliance Location

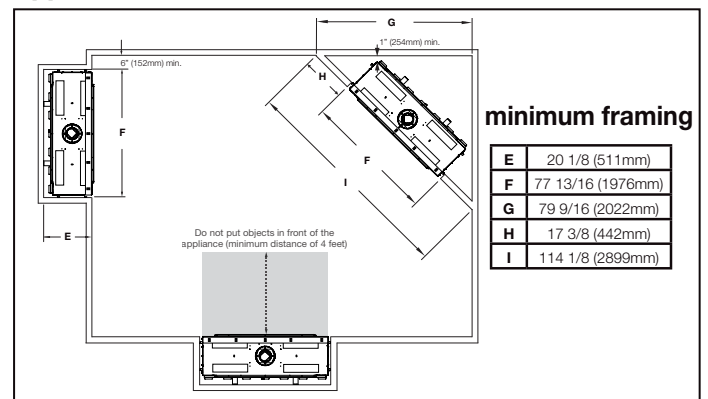

W415-4143 / C-0 / 04.09.24

## Spécifications: Simple face

Modèle	BTU	Largeur		Hauteur		Profondeur		Dimensions de Vision
		Réel	Ossature	Réel	Ossature	Réel	Ossature	
TLV62N	44 000	77 5/16	77 13/16	47 15/16	48 3/16	19 7/8	20 1/8	64 9/16 X 26 13/16
TLV62LN								
TLV62P	38 000	77 5/16	77 13/16	47 15/16	48 3/16	19 7/8	20 1/8	
TLV62LP								

## Dimensions: Simple face

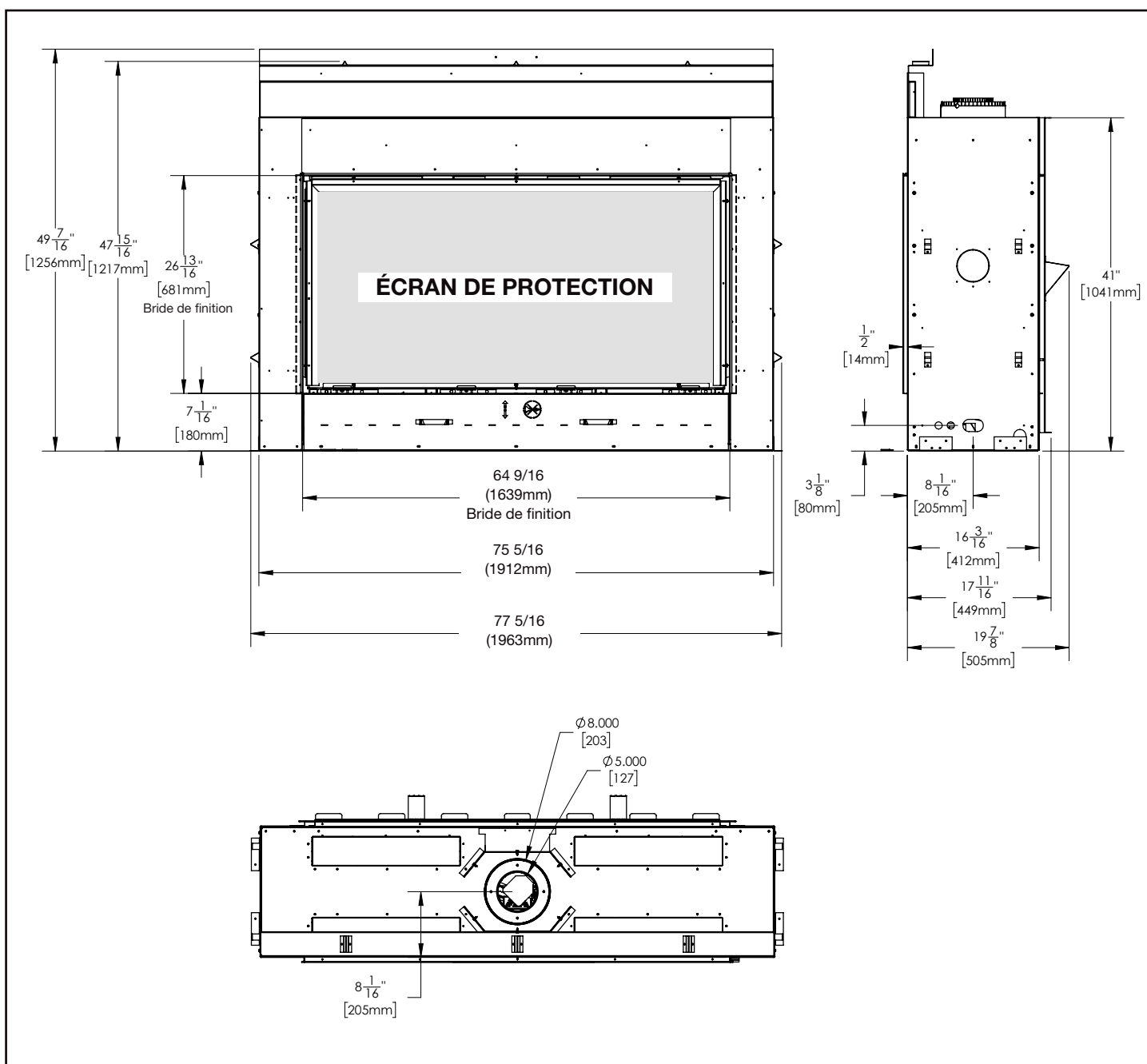

Information du produit fourni n'est pas complet et est sujet de changer sans préavis. Consultez le manuel d'installation pour information d'installation actuel.

W415-4143 / C-0 / 04.09.24

## Spécifications: Transparent

Modèle	BTU	Largeur		Hauteur		Profondeur		Dimensions de Vision
		Réel	Ossature	Réel	Ossature	Réel	Ossature	
TLV62N2	44 000	77 5/16	77 13/16	47 15/16	48 3/16	16 3/16	16 3/16	64 9/16 X 26 13/16
TLV62LN2								
TLV62P2	38 000	77 5/16	77 13/16	47 15/16	48 3/16	16 3/16	16 3/16	
TLV62LP2								

## Dimensions: Transparent

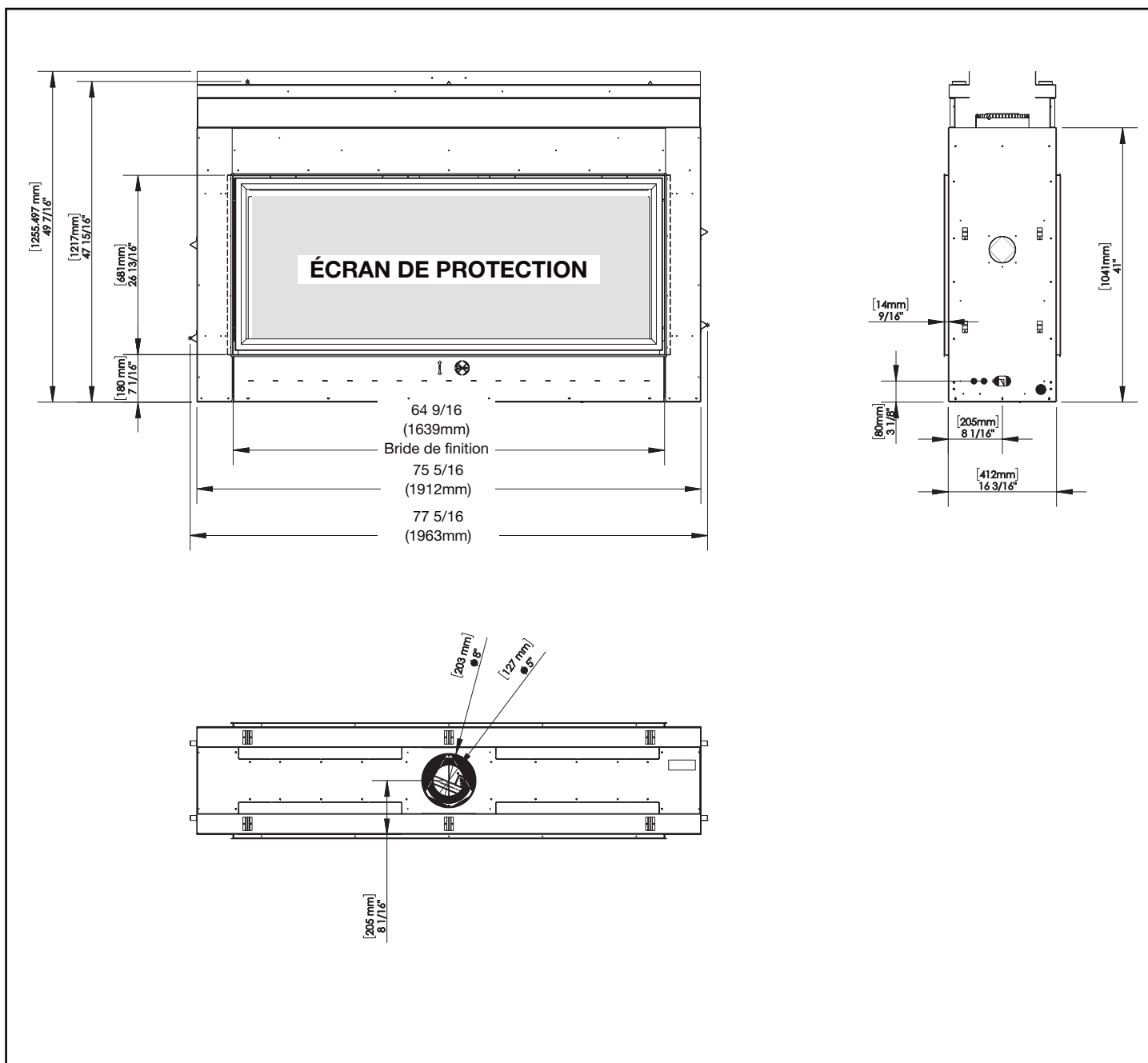

Information du produit fourni n'est pas complet et est sujet de changer sans préavis. Consultez le manuel d'installation pour information d'installation actuel.

W415-4143 / C-0 / 04.09.24

# SÉRIE VECTOR<sup>MD</sup> GRAND 62 FOYER À GAZ D'ÉVACUATION DIRECTE



Information du produit fourni n'est pas complet et est sujet de changer sans préavis. Consultez le manuel d'installation pour information d'installation actuel.

## Ossature Finis

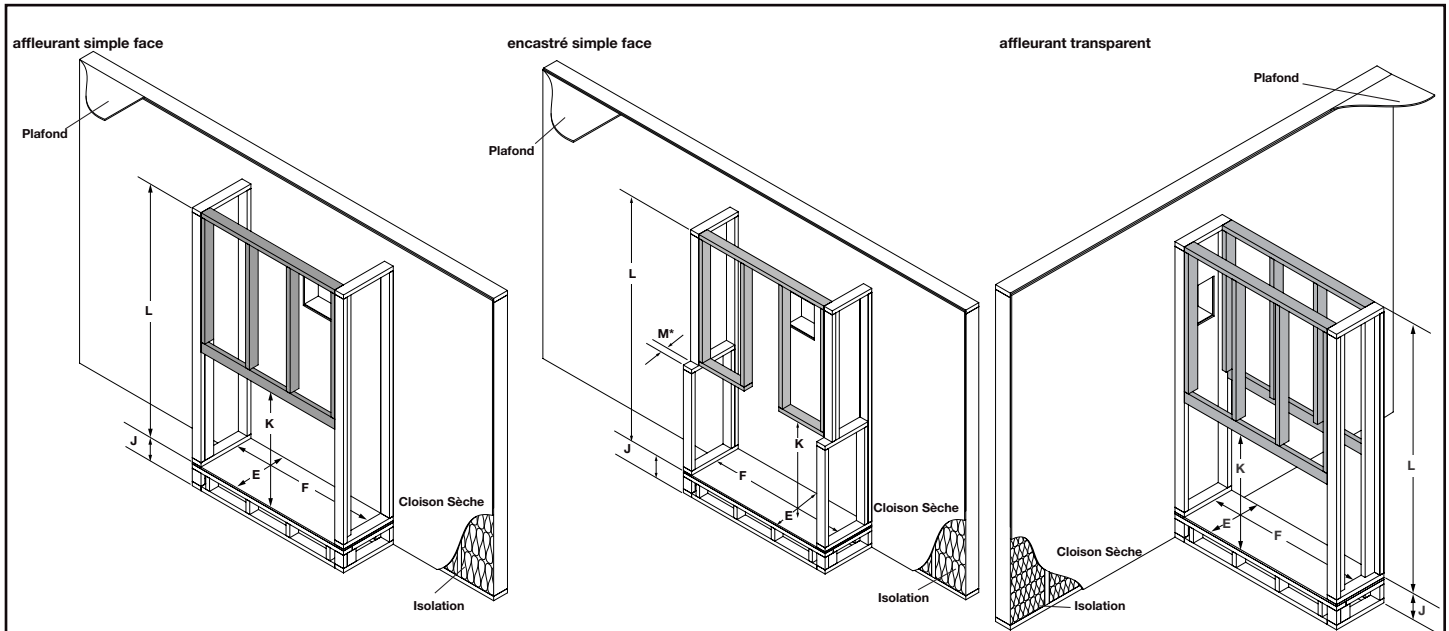

Réf.	TLV62 / TLV62L simple face
K	48 3/16" (1224mm)
E	20 1/8" (511mm)
F	77 13/16" (1976mm)
J	Optionnel - L'appareil ne doit pas être élevé au-dessus du plancher.
L	91" (2311mm)
M*	3" (76mm)

Réf.	TLV62_2 / TLV62L2 transparent
K	48 3/16" (1224mm)
E	16 3/16" (411mm)
F	77 13/16" (1976mm)
J	Optionnel - L'appareil ne doit pas être élevé au-dessus du plancher.
L	91" (2311mm)

\*On ne peut augmenter que 4" max en construisant une saillie.

### note:

La séries TLV requies un minimum hauteur d'enceinte/plafond, comme illustré (dimension L), mesuré du bas de l'appareil. Pour les exigences de températures, cet espace doit être dégager. Certains configurations qui requies un enceinte plus large pour fournir les dégagements minimaux entre les conduits d'évacuation et les combustibles.

## Dimensions Minimales de l'Encadrement

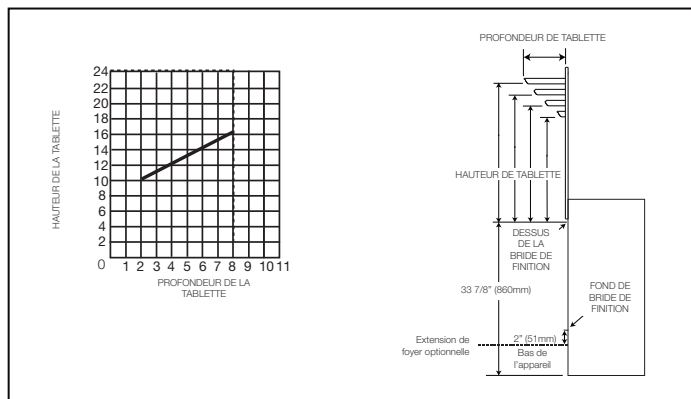

## Emplacement de l'Appareil

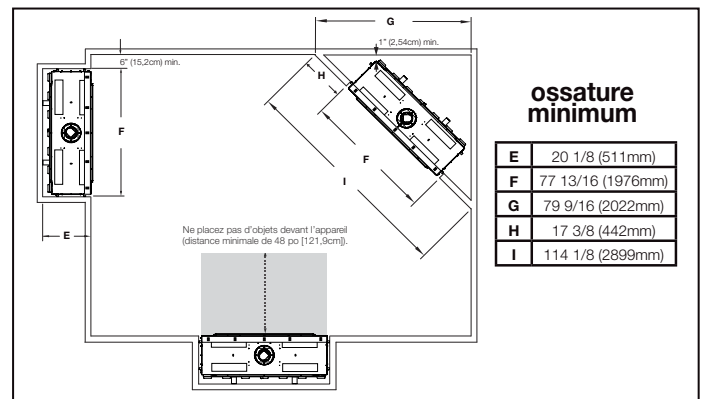

W415-4143 / C-0 / 04.09.24